



Belmont Close, Totteridge, N20 8QT
Price Guide £1,395,000 Freehold Council Tax Band G

REAL ESTATES
Est.1981

Estate Agents · Residential Sales · Investments · Lettings

NEW INSTRUCTION- FANTASTIC OPPORTUNITY TO acquire for sale this rarely available 5 BEDROOM, 2 BATHROOM DETACHED home situated in one of Totteridge's most desirable roads. Belmont Close is a quiet cul-de-sac in the heart of Totteridge, surrounded by open space and South Herts Golf Club.

The property is currently arranged over 3 floors and offers further potential to extend, subject to relevant planning permissions. Further benefits include a garage via own driveway providing off street parking for 2/3 cars. Requires some updating

Viewing is highly recommended via sole agent Real Estates







Belmont Close, London, N20

Approximate Area = 2246 sq ft / 209 sq m (includes garage)

Limited Use Area(s) = 167 sq ft / 16 sq m

Total = 2413 sq ft / 225 sq m

For identification only - Not to scale

Denotes restricted
head height

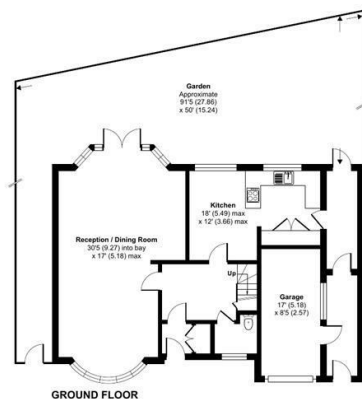

Floor plan produced in accordance with RICS Property Measurement Standards incorporating International Property Measurement Standards (IPMS Residential). © nrichcom 2022. Produced for Real Estates - REF: 931032

Energy Efficiency Rating		
Very energy efficient - lower running costs	Current	Potential
A (91-100)		80
B (81-90)		
C (71-80)		
D (61-70)		43
E (51-60)		
F (41-50)		
G (31-40)		
Not energy efficient - higher running costs		
EU Directive		



Real EstatesTotteridge Office:
32 Totteridge Lane
Totteridge N20 9QJ

ll : 0208 445 3132
e : info@realestates-wsp.co.uk
w : www.realestates-wsp.co.uk